

SDB704CA Silicon Epitaxial Planar Schottky Barrier Diode

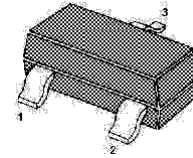
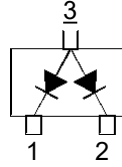

Marking Code: "XY"
SOT-23 Plastic Package

Absolute Maximum Ratings ($T_a = 25^\circ\text{C}$)

Parameter	Symbol	Value	Unit
Reverse Voltage	V_R	30	V
Forward Current (Single)	I_F	30	mA
Forward Current (Double)		20	
Peak Forward Current (Single)	I_{FM}	150	mA
Peak Forward Current (Double)		110	
Junction Temperature	T_j	125	$^\circ\text{C}$
Storage Temperature Range	T_{stg}	- 55 to + 125	$^\circ\text{C}$

Characteristics at $T_a = 25^\circ\text{C}$

Parameter	Symbol	Typ.	Max.	Unit
Forward Voltage at $I_F = 1\text{ mA}$ at $I_F = 30\text{ mA}$	V_F	-	0.4	V
		-	1	
Reverse Current at $V_R = 30\text{ V}$	I_R	-	1	μA
Terminal Capacitance at $V_R = 1\text{ V}$, $f = 1\text{ MHz}$	C_t	2.7	-	pF
Reverse Recovery Time at $I_F = I_R = 10\text{ mA}$, $I_{rr} = 1\text{ mA}$, $R_L = 100\ \Omega$	t_{rr}	1	-	ns

Typical Characteristics

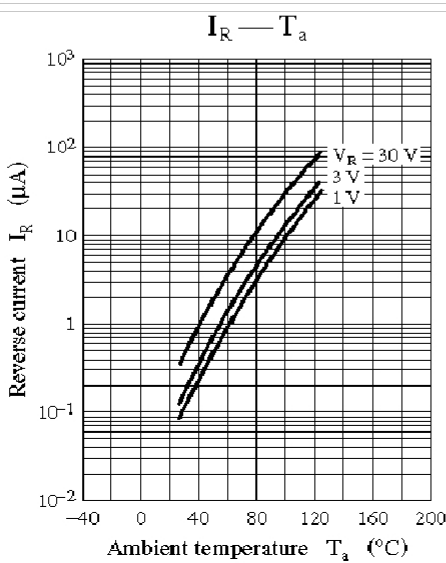
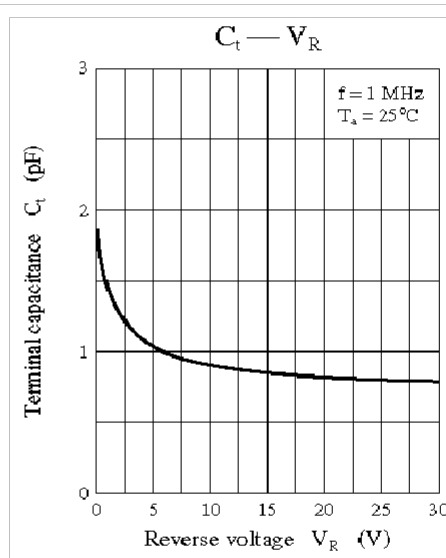
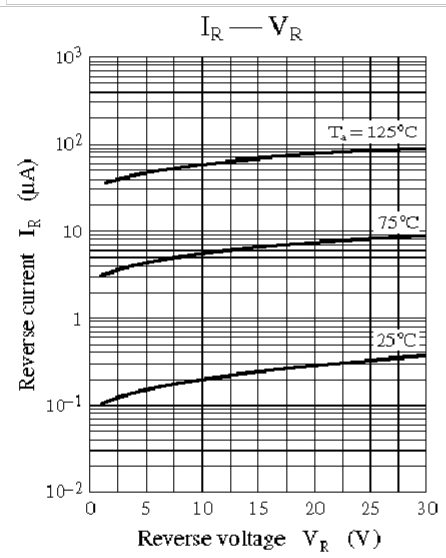
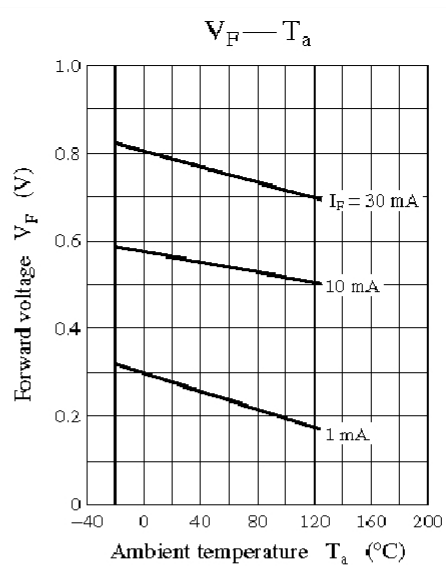
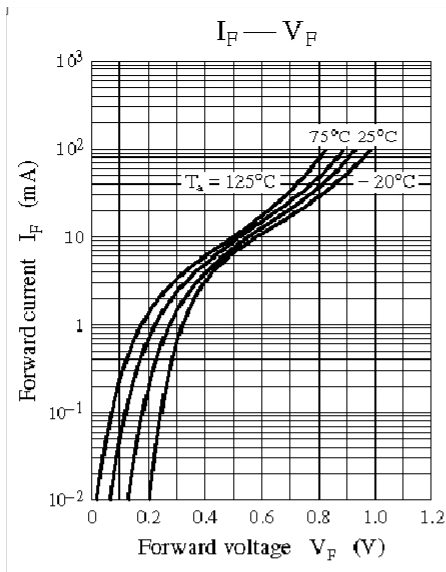

PACKAGE OUTLINE

Plastic surface mounted package; 3 leads

SOT-23

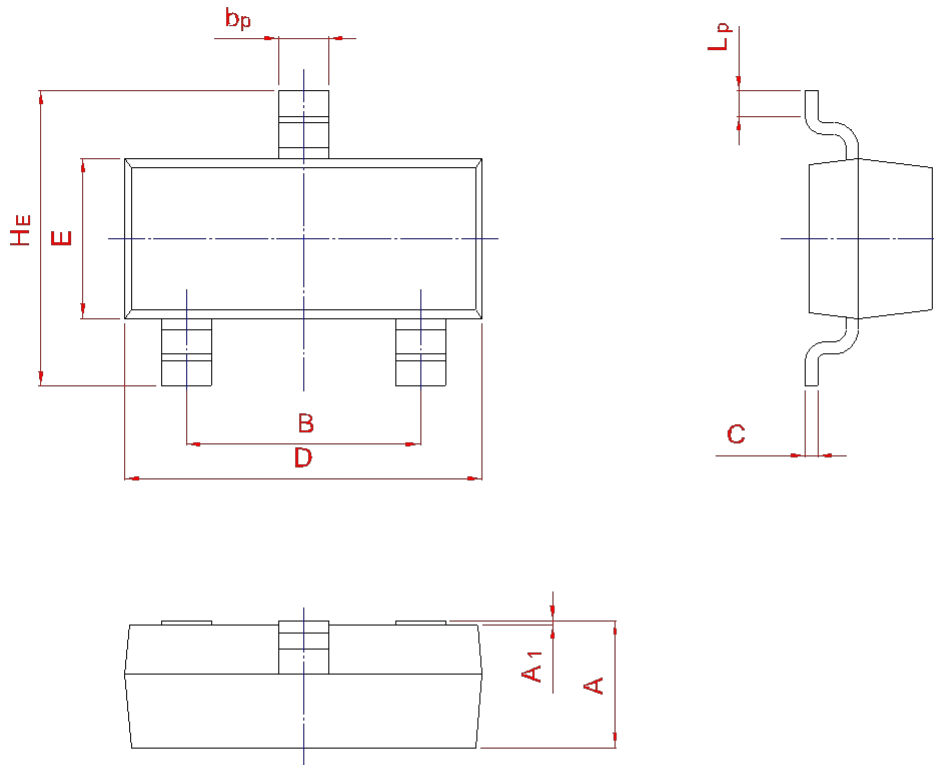
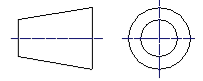

UNIT	A	B	bp	C	D	E	He	A1	Lp
mm	1.40	2.04	0.50	0.19	3.10	1.65	3.00	0.100	0.50
	0.95	1.78	0.35	0.08	2.70	1.20	2.20	0.013	0.20