

**SB420D SILICON EPITAXIAL PLANAR SCHOTTKY BARRIER DIODE**

for low power rectification

**Features**

- Small surface mounting type.
- High reliability.

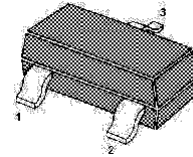
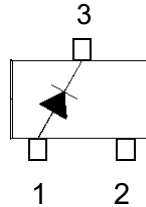

SOT-23 Plastic Package

Marking Code: **FF**

**Absolute Maximum Ratings (T<sub>a</sub>= 25°C)**

Parameter	Symb l	Value	Unit
Maximum Peak Reverse Voltage	V <sub>RM</sub>	40	V
DC Reverse Voltage	V <sub>R</sub>	40	V
Mean Rectifying Current	I <sub>O</sub>	0.1	A
Peak Forward Surge Current <sup>1)</sup>	I <sub>FSM</sub>	1	A
Junction Temperature	T <sub>j</sub>	125	°C
Storage Temperature Range	T <sub>s</sub>	-40 to +125	°C

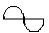
<sup>1)</sup>60Hz for 1 

**Characteristics at T<sub>a</sub> = 25°C**

Parameter	Symbol	Min	Typ	Max	Unit
Forward Voltage at I <sub>F</sub> = 10mA	V <sub>F</sub>	-	-	0.45	V
Reverse Current at V <sub>R</sub> = 10V	I <sub>R</sub>	-	-	1	μA
Capacitance Between Terminals at V <sub>R</sub> = 10V, f=1MHz	C <sub>T</sub>	-	6	-	pF

## Typical Characteristics

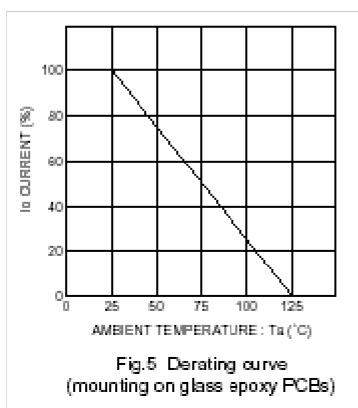
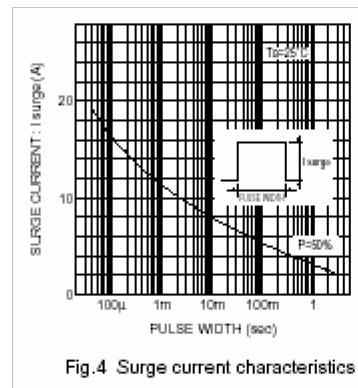
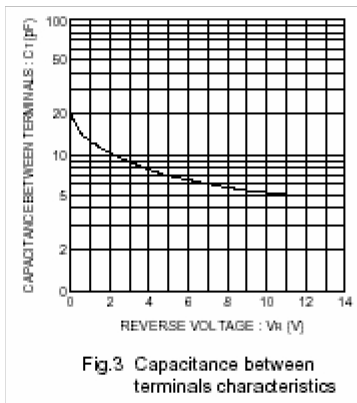
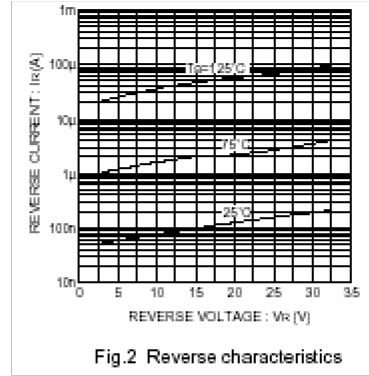
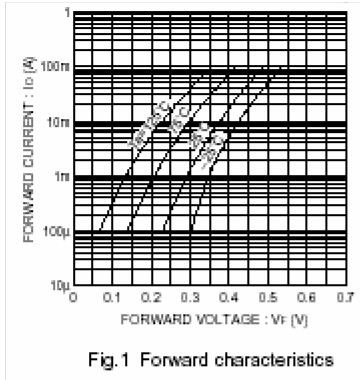

PACKAGE OUTLINE

Plastic surface mounted package; 3 leads

SOT-23

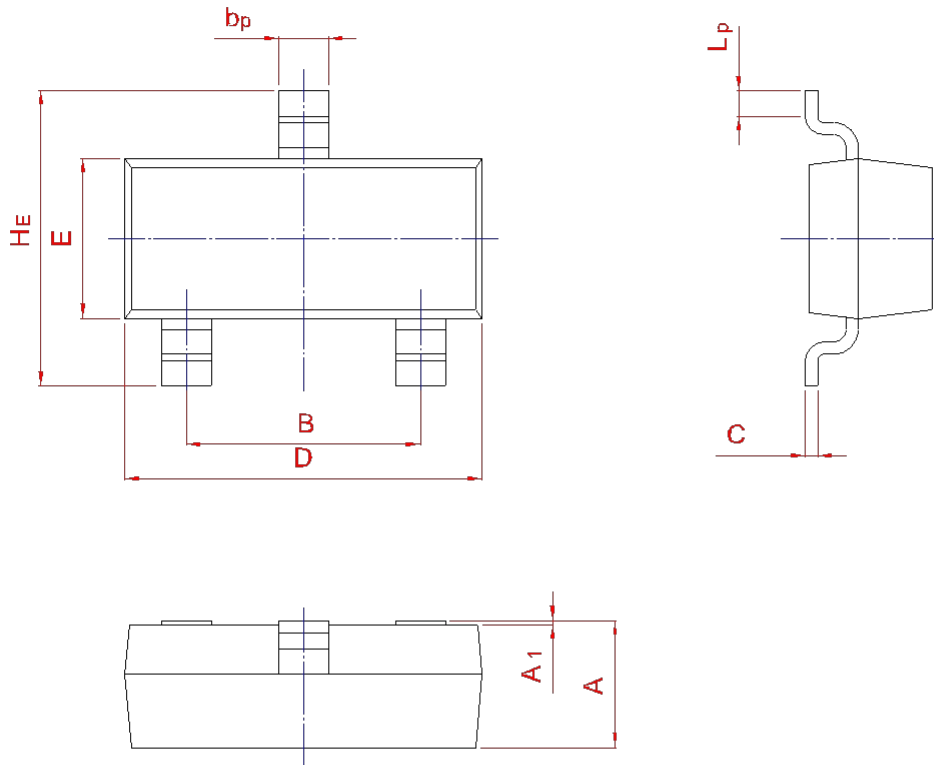
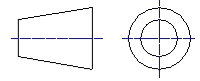

UNIT	A	B	bp	C	D	E	He	A1	Lp
mm	1.40	2.04	0.50	0.19	3.10	1.65	3.00	0.100	0.50
	0.95	1.78	0.35	0.08	2.70	1.20	2.20	0.013	0.20